



RF Components

8-Way S-Band Passive Splitter/Combiner

700 - 2700 MHz

Model Number:
COM08S1P-2605

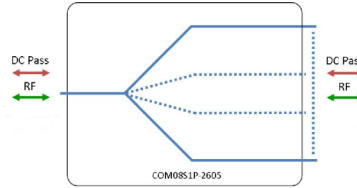

- All RF ports DC pass

Available with RF connector options:

- 50 Ω SMA
- 50 Ω N-type
- 50 Ω BNC



700 - 2700 MHz
Operating frequency range. S-Band ready



Compact
Housed in rugged compact enclosure



Flexible Mounting
Tapped screw & through hole mounting options

Passive

RF Parameters			
COM08S1P-2605-XXXX	S5S5	N5N5	B5B5
Frequency Range	700-2700 MHz		
RF Connectors	50Ω SMA	50Ω N-Type	50Ω BNC
Mean Insertion Loss (dB)	2.0±1.0	2.0±1.0	2.0±1.0
Flatness ± (dB)	1.5	1.5	1.5
Input Return Loss (dB)	Typ.	18	18
	Min	15	15
Output Return Loss (dB)	Typ.	15	15
	Min	12	12
Isolation (dB)	Typ.	16	16
Amplitude Balance (dB)	≤0.5	≤0.5	≤0.5
Phase Balance (Φ)	≤5°	≤5°	≤5°
The given Insertion Loss specified is the loss above the theoretical limit for a lossless divider			

Broadcast



Marine Oil & Gas



SNG & VSAT



Satellite Teleport



Technical specifications and operating parameters

Environmental		
Operating Temperature		0°C to +45°C
Storage Temperature		-20°C to +75°C
Location		Indoor use Only
Humidity	Max.	85% non-condensing
Altitude	Max.	10,000 feet

Max Operating Parameters	
Input RF Power	+16dBm
DC Voltage	48V on any RF port
DC Current	3A
DC Consumption	N/A

! Operation beyond these limits may cause instantaneous and permanent damage.

Physical Dimensions (mm)

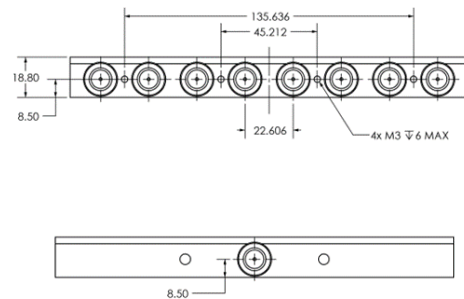
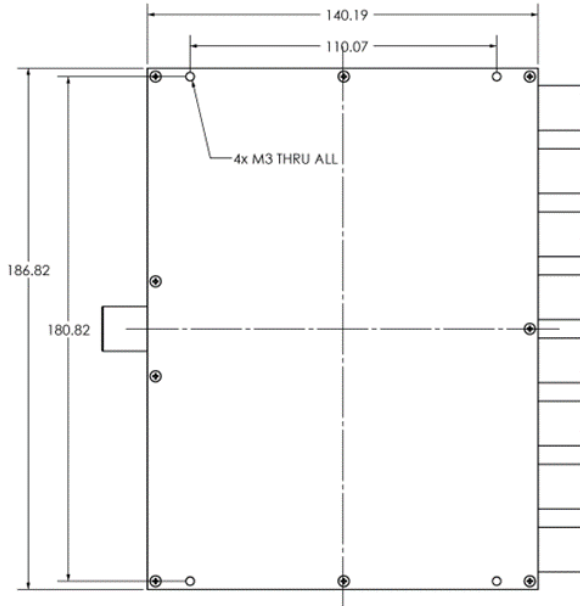

Note: The specification is subject to regular reviews and will be updated from time to time as part of our continuing product development and improved specification accuracy.